

Montageanleitung 64027

Mounting instruction 64027

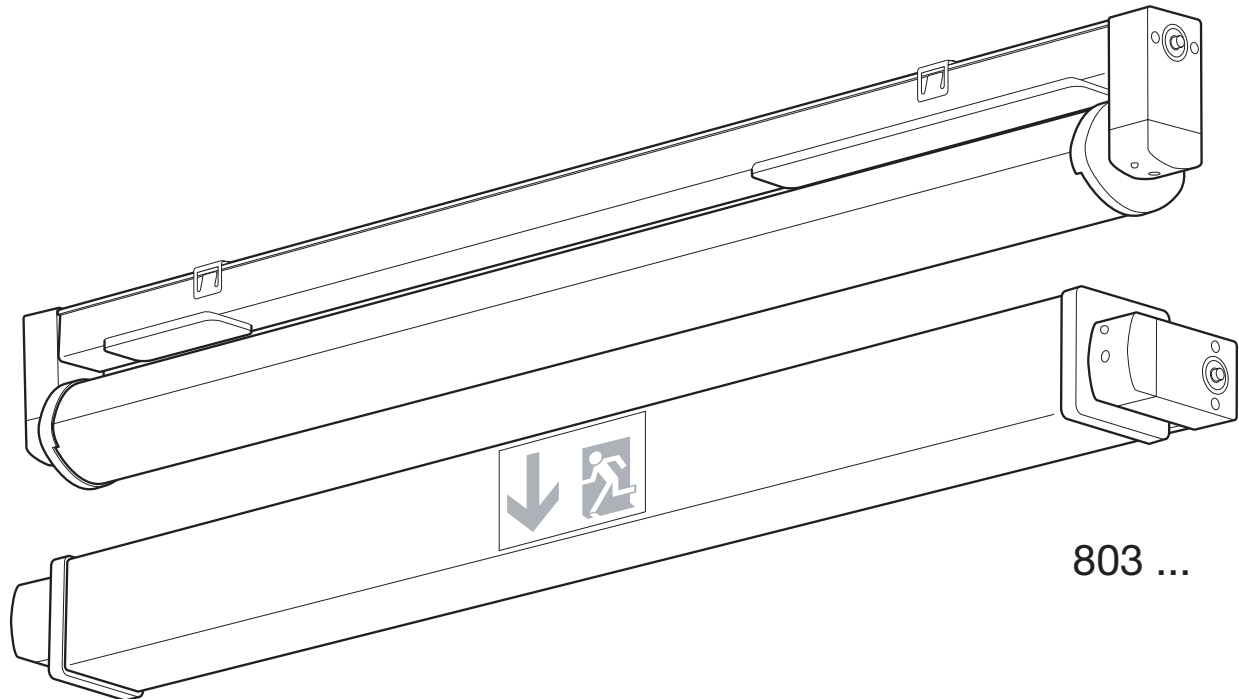

IP 65  T_a -5°C ... +30°C (Dauerbetrieb / *permanent mode*)
230 V / 50 Hz T_a 0°C ... +35°C (Bereitschaftsschaltung / *standby mode*)
max. 5,4 kg
mit automatischem Selbsttest / *with automatic self-test*

Lampenlichtstromfaktor K / *light output K*

1 x T8	18W	1h	K = 15%				
1 x T8	36W	1h	K = 25%	1 x T5	35W	1h	K = 30%
1 x T8	36W	3h	K = 10%	1 x T5	35W	3h	K = 10%
1 x T8	58W	1h	K = 20%	1 x T5	39W	1h	K = 25%
1 x T8	58W	3h	K = 10%	1 x T5	39W	3h	K = 10%
1 x T5	14W	1h	K = 20%	1 x T5	49W	1h	K = 20%
1 x T5	21W	1h	K = 40%	1 x T5	49W	3h	K = 15%
1 x T5	21W	3h	K = 20%	1 x T5	54W	1h	K = 20%
1 x T5	24W	1h	K = 10%	1 x T5	54W	3h	K = 5%
1 x T5	28W	1h	K = 40%	1 x T5	80W	1h	K = 15%
1 x T5	28W	3h	K = 15%	1 x T5	80W	3h	K = 5%

Zum Einsatz in Notbeleuchtungsanlagen nach VDE 0108 (DIN EN 50172)

To be mounted in emergency lighting installations according to VDE 0108 (DIN EN 50172)

NORKA

Inbetriebnahme

Nach Fertigstellung der Anschlüsse zunächst den Batteriestecker verbinden.
Nachdem die Netzspannung anliegt, kann es zu verschiedenen Anzeigen kommen (siehe optische Status-Anzeige LED).
Die Notleuchten sollten für die volle Funktionstüchtigkeit mind. 48 Std. am Netz angeschlossen sein.





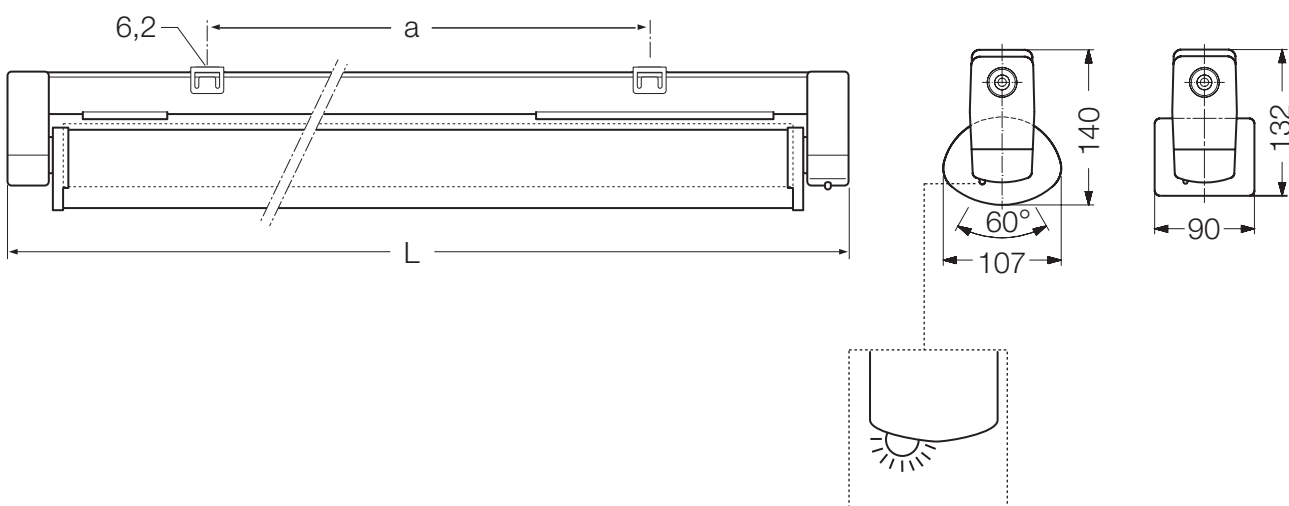

Putting into operation

After preparing the luminaire terminals at first connect the battery plug.
After the luminaire is connected to the mains, several modes may be indicated (see optical status-indication LED).
For full operational readiness the emergency luminaire should be connected to the supply voltage at least 48 hours.



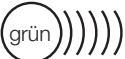
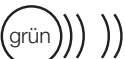

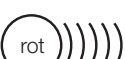



P [W]	L [mm]	a [mm]
18	641	420 ± 30
36	1251	980 ± 80
58	1551	1280 ± 80
14	600	350 ± 30
21	900	650 ± 50
24	600	350 ± 30
28	1200	930 ± 80
35	1500	1230 ± 80
39	900	650 ± 50
49	1500	1230 ± 80
54	1200	930 ± 80
80	1500	1230 ± 80

Optische Status-Anzeige

	grün leuchtend	System in Ordnung
	grün langsam blinkend	Laufzeittest aktiv
	grün schnell blinkend	Funktionstest aktiv
	grün doppelt blinkend	Ruhe-Betrieb
	rot leuchtend	Lampenfehler
	rot langsam blinkend	Akkufehler
	rot schnell blinkend	Ladefehler
	aus	keine Netzspannung oder Notlichtelement defekt

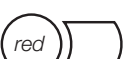
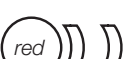
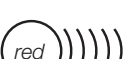
Optical status display

	<i>green illuminated</i>	<i>system ok</i>
	<i>green slowly blinking</i>	<i>running time activ</i>
	<i>green fast blinking</i>	<i>function test activ</i>
	<i>green double blinking</i>	<i>rest mode</i>
	<i>red illuminated</i>	<i>lamp fault</i>
	<i>red slowly blinking</i>	<i>battery fault</i>
	<i>red fast blinking</i>	<i>charging fault</i>
	<i>off</i>	<i>no supply voltage or emergency lighting is not working</i>

Automatischer Testablauf / *Automatic self-test routine*

Festlegung Test-Tag/Zeit
Definition of test day/time

Installation / *Installation*

Nach 5 Tagen ununterbrochen
am Netz Inbetriebnahmetest
in den nächsten 1-28 Tagen
(bewusste Streuung)
*After 5 days of continuous mains
connection the initiation test
happen during the next 1-28
days (deliberate spreading)*

Inbetriebnahmetest / *Initiation test*

wöchentlich / *weekly*

Funktionstest / *Function test*

jährlich / *annual*

Laufzeitest / *Run-time test*

Funktionstest (30 Sekunden) / *Function test (30 seconds)*

- Notlichtelement / *emergency lighting unit*
- Leuchtmittel / *lamp*
- Batterie / *battery*

Laufzeitest (gesamte Laufzeit) / *Run-time test (complete operation time)*

- Notlichtelement / *emergency lighting unit*
- Leuchtmittel / *lamp*
- Batterie / *battery*
- Batteriekapazität / *capacity of battery*

Zusätzlich wird im Netzbetrieb kontinuierlich die Ladung des Akkus überwacht.
Im Notbetrieb wird ein defektes Leuchtmittel erkannt.
Fehleranzeigen erfolgen über die optische Statusanzeige /LED).

*In addition the charging of the battery is monitored during the mains operation.
During emergency service a defective lamp will be detected.
Error indication is carried out by optical-status-indication (LED).*

A

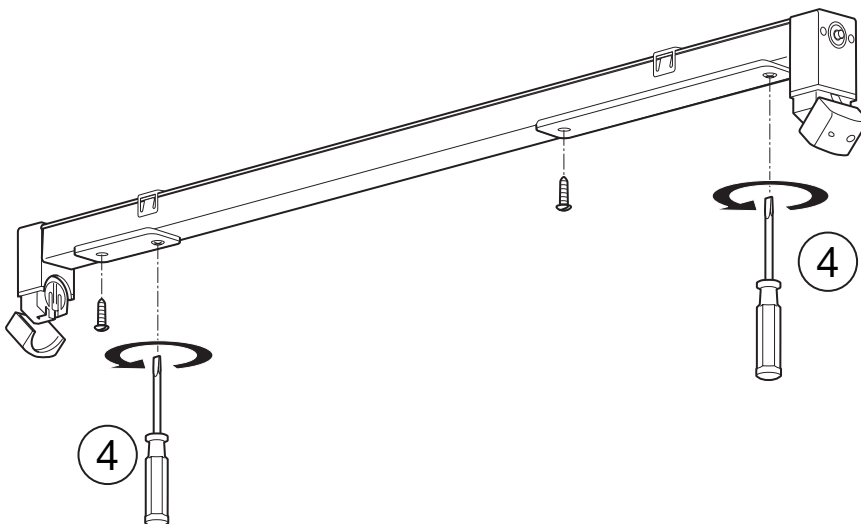
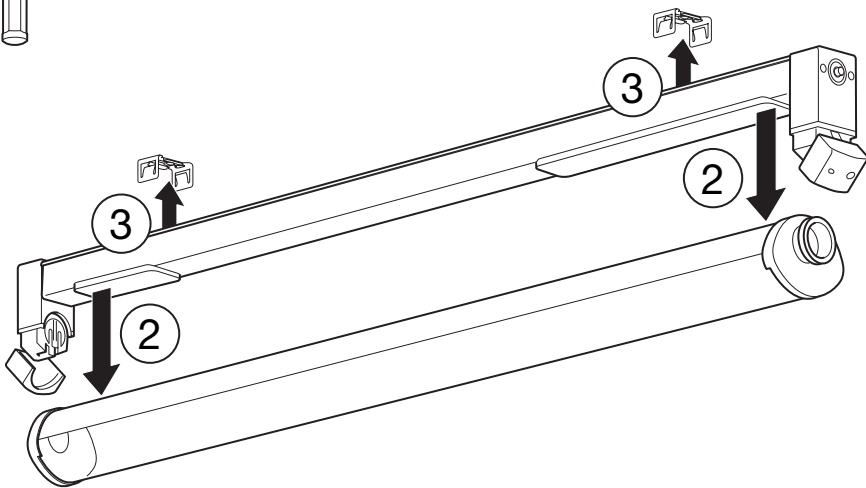
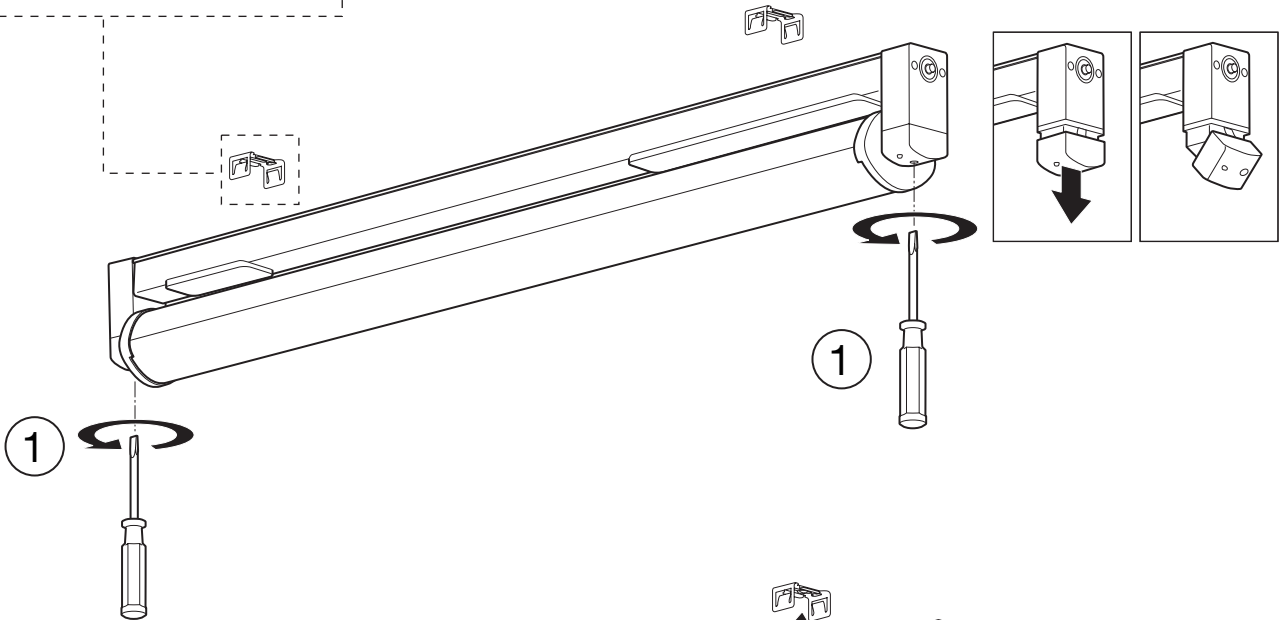
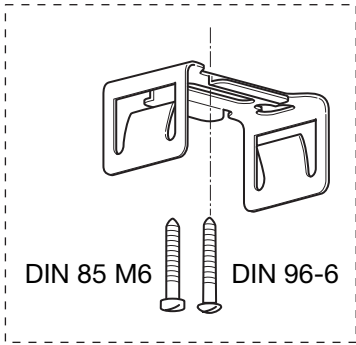

B

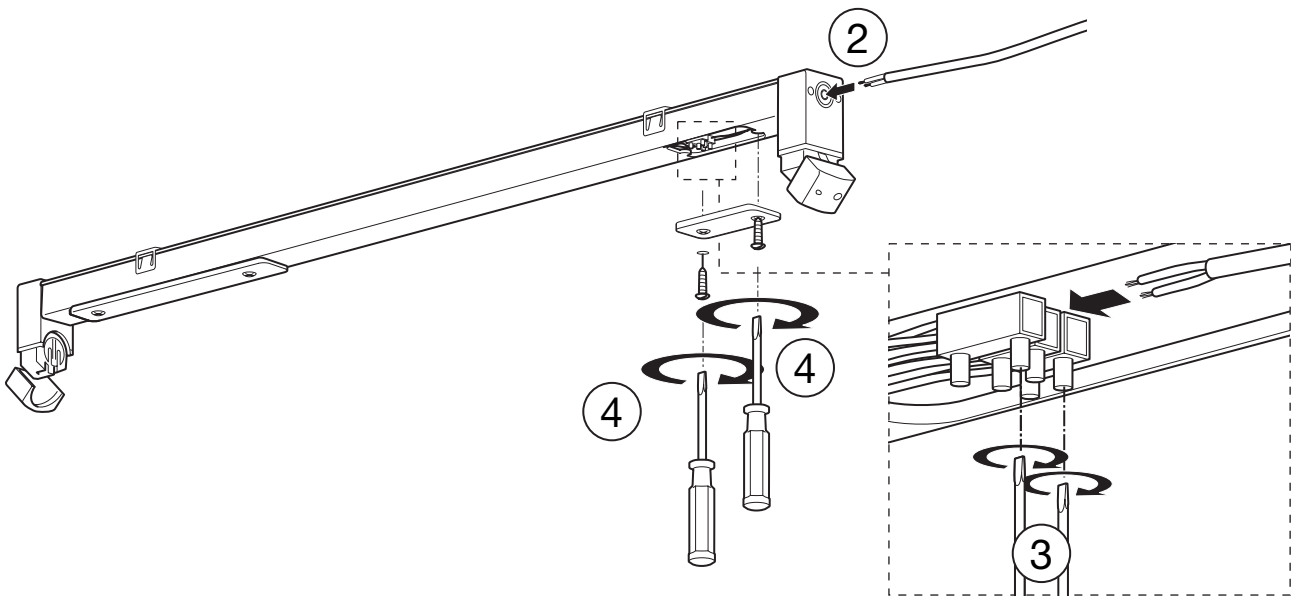
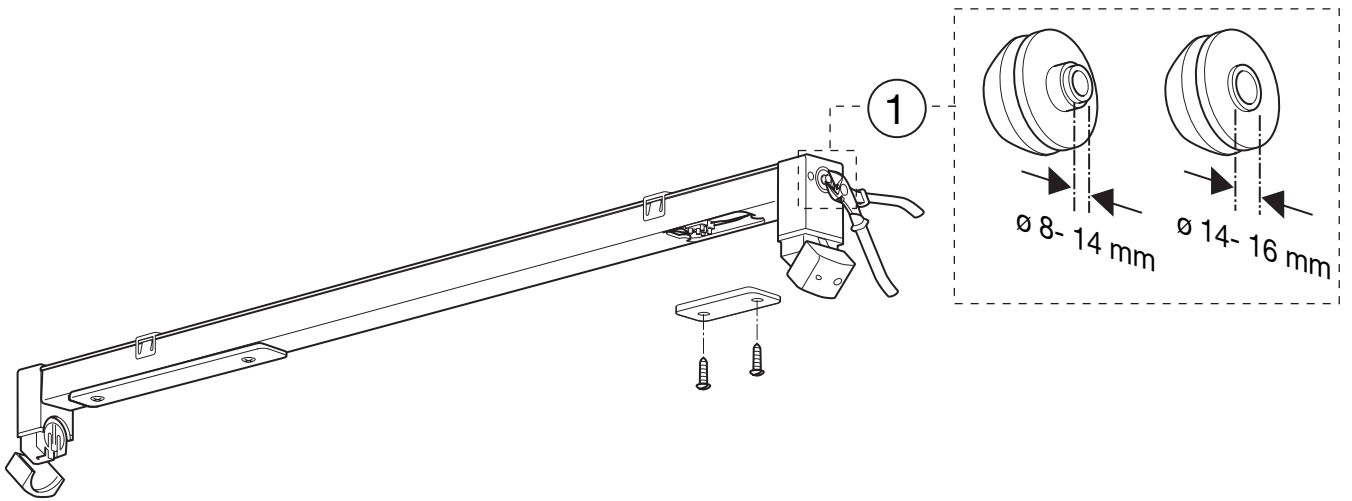

Bereitschaftsschaltung
Standby mode

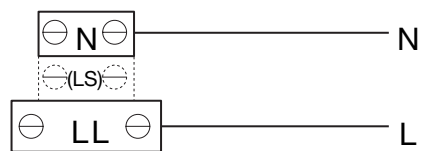

Dauerbetrieb
Permanent mode

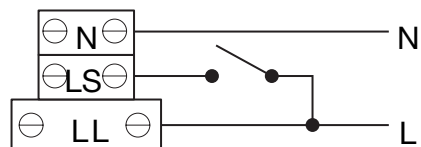

Batteriewechsel stirnseitig
Change of batteries frontal

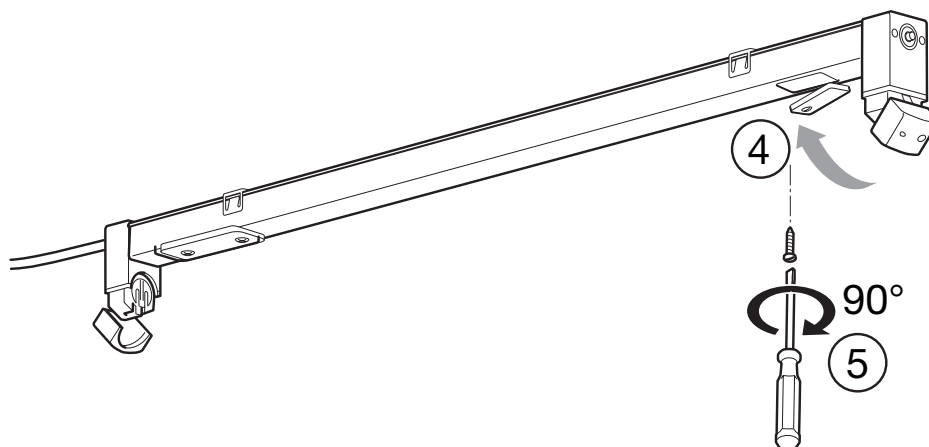
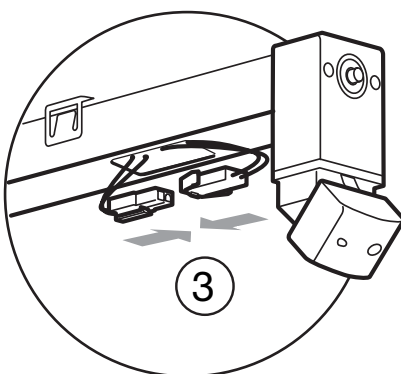
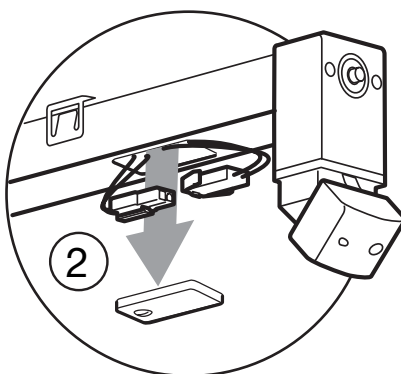
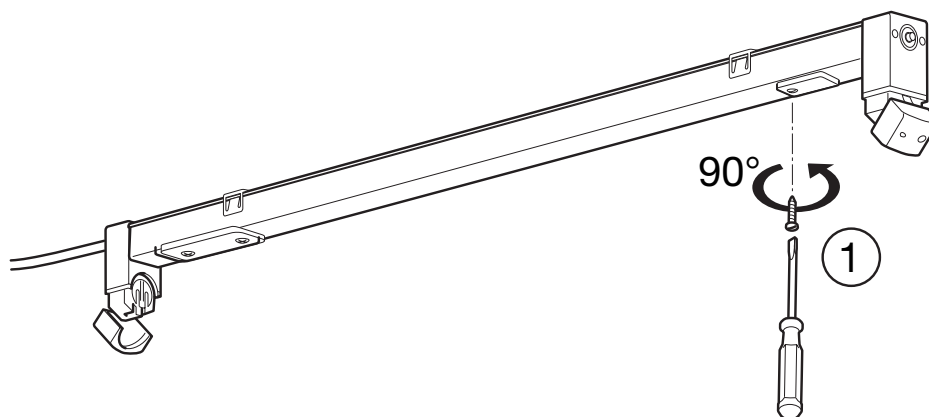

Batteriewechsel über Deckel
Change of batteries through access cover

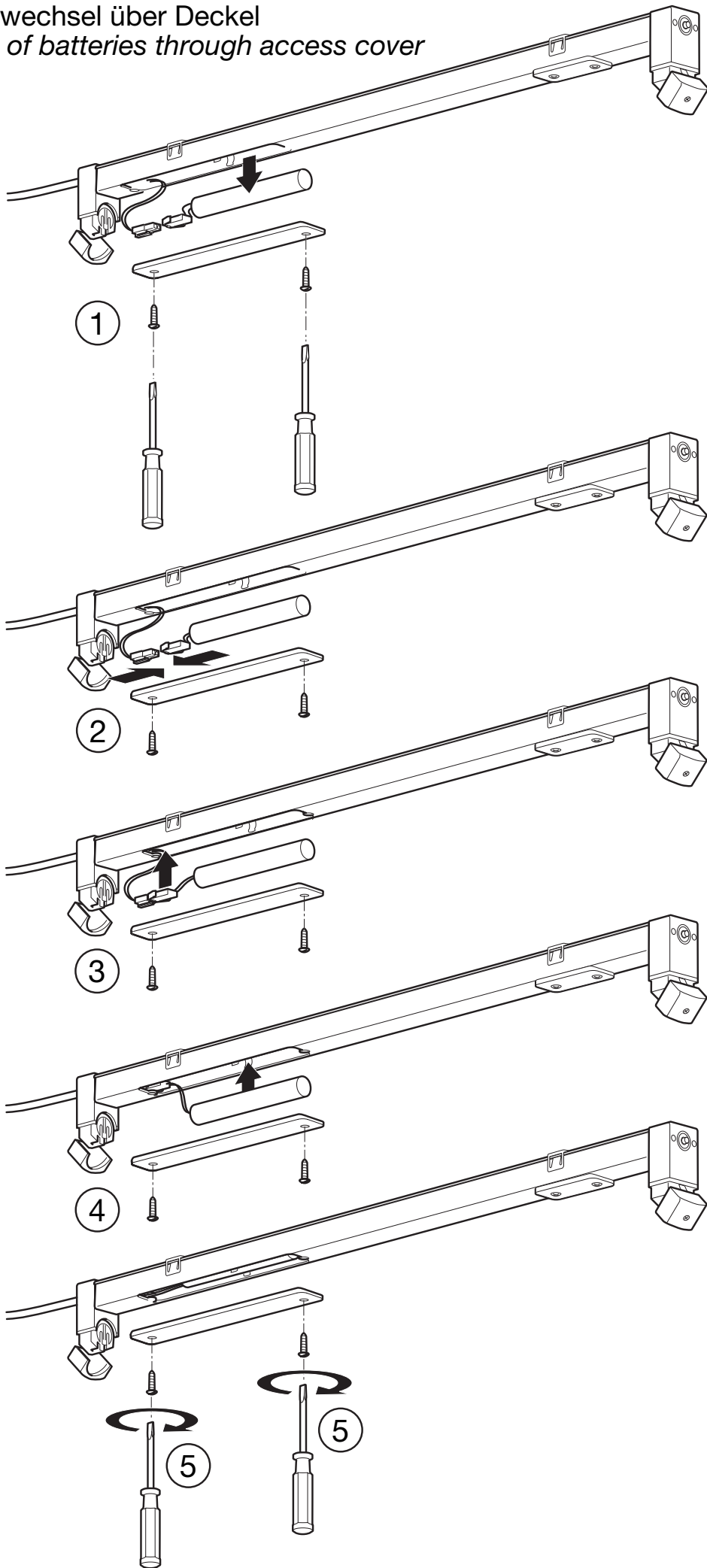

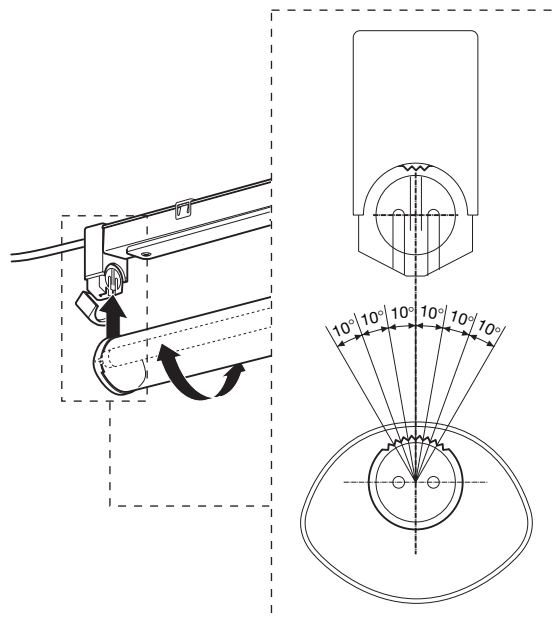
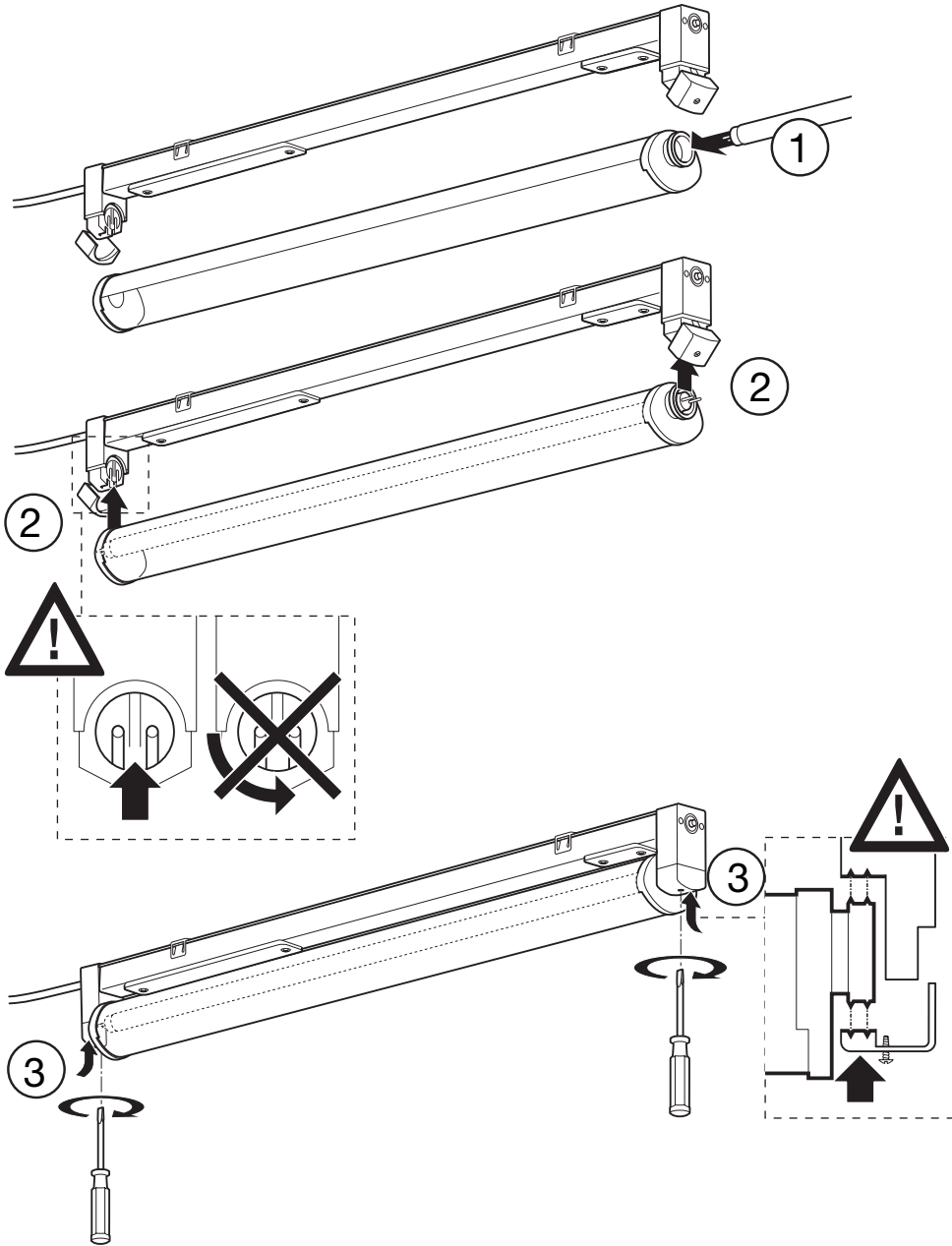



Bei Unterschreiten der Grenzbetriebsdauer
sind nach VDE 0108 die Batterien zu wechseln.

*When falling below the limit of the operating time
the battery sets have to be changed according VDE 0108.*



Batterietypen / Batterytypes

1 x T8	18W	1h	K = 15%	NiCd 4,8V/1,2Ah
1 x T8	36W	1h	K = 25%	NiCd 4,8V/4,0Ah
1 x T8	36W	3h	K = 10%	NiCd 4,8V/4,0Ah
1 x T8	58W	1h	K = 20%	NiCd 6,0V/4,0Ah
1 x T8	58W	3h	K = 10%	NiCd 6,0V/4,0Ah
1 x T5	14W	1h	K = 20%	NiCd 4,8V/1,2Ah
1 x T5	21W	1h	K = 40%	NiCd 6,0V/4,0Ah
1 x T5	21W	3h	K = 20%	NiCd 6,0V/4,0Ah
1 x T5	24W	1h	K = 10%	NiCd 4,8V/1,2Ah
1 x T5	28W	1h	K = 40%	NiCd 7,2V/4,0Ah
1 x T5	28W	3h	K = 15%	NiCd 7,2V/4,0Ah
1 x T5	35W	1h	K = 30%	NiCd 7,2V/4,0Ah
1 x T5	35W	3h	K = 10%	NiCd 7,2V/4,0Ah
1 x T5	39W	1h	K = 25%	NiCd 7,2V/4,0Ah
1 x T5	39W	3h	K = 10%	NiCd 7,2V/4,0Ah
1 x T5	49W	1h	K = 20%	NiCd 7,2V/4,0Ah
1 x T5	49W	3h	K = 15%	NiCd 7,2V/4,0Ah
1 x T5	54W	1h	K = 20%	NiCd 7,2V/4,0Ah
1 x T5	54W	3h	K = 5%	NiCd 7,2V/4,0Ah
1 x T5	80W	1h	K = 15%	NiCd 7,2V/4,0Ah
1 x T5	80W	3h	K = 5%	NiCd 7,2V/4,0Ah

Achtung! / Attention!

Batteriewechsel nur durch Fachpersonal!

Weitere Informationen zum automatischen Selbsttest auf Anfrage!

Change of battery only through authorized personnel!

Further information in regards to the automatic self-test upon request!

Notizen / Notice

NORKA

NORDDEUTSCHE KUNSTSTOFF-
UND ELEKTRO-GESELLSCHAFT
STÄCKER MBH & CO. KG

Lichttechnische Spezialfabrik

Sportallee 8
D-22335 Hamburg

Postfach 63 02 63
D-22312 Hamburg

Tel.: +49 40 - 51 30 09 - 0
Fax: +49 40 - 51 30 09 - 28

www.norka.de
info@norka.de